



BACKSTAGE ACCOMMODATIONS ARE TAILORED TO MEET THE needs of all touring artists. Locker rooms, dressing rooms and multi-purpose rooms are all conveniently located.

private star dressing rooms & locker rooms

- (1) 15' x 20' dressing room attached private bathroom and shower floor length mirrors and vanity table
- (1) 13' x 20' dressing room attached private bathroom and shower floor length mirrors and vanity table
- (2) 10' x 12' dressing rooms attached bathrooms and shower
- (2) 30' x 16' locker rooms attached bathrooms and showers (20) full length lockers and large marker board
- furniture and catering available upon request

multi-purpose rooms

- interview room 30' x 25'
- press room 28' x 27' with additional 27' x 20' work area and attached bathrooms
- green room 20' x 30'

hospitality

All needs for meals, beverage service, towels, dry cleaning and errand service will be handled professionally in true Clemson style.

*regulation:
University funds cannot be used to purchase alcohol for performers.



backstage accommodations

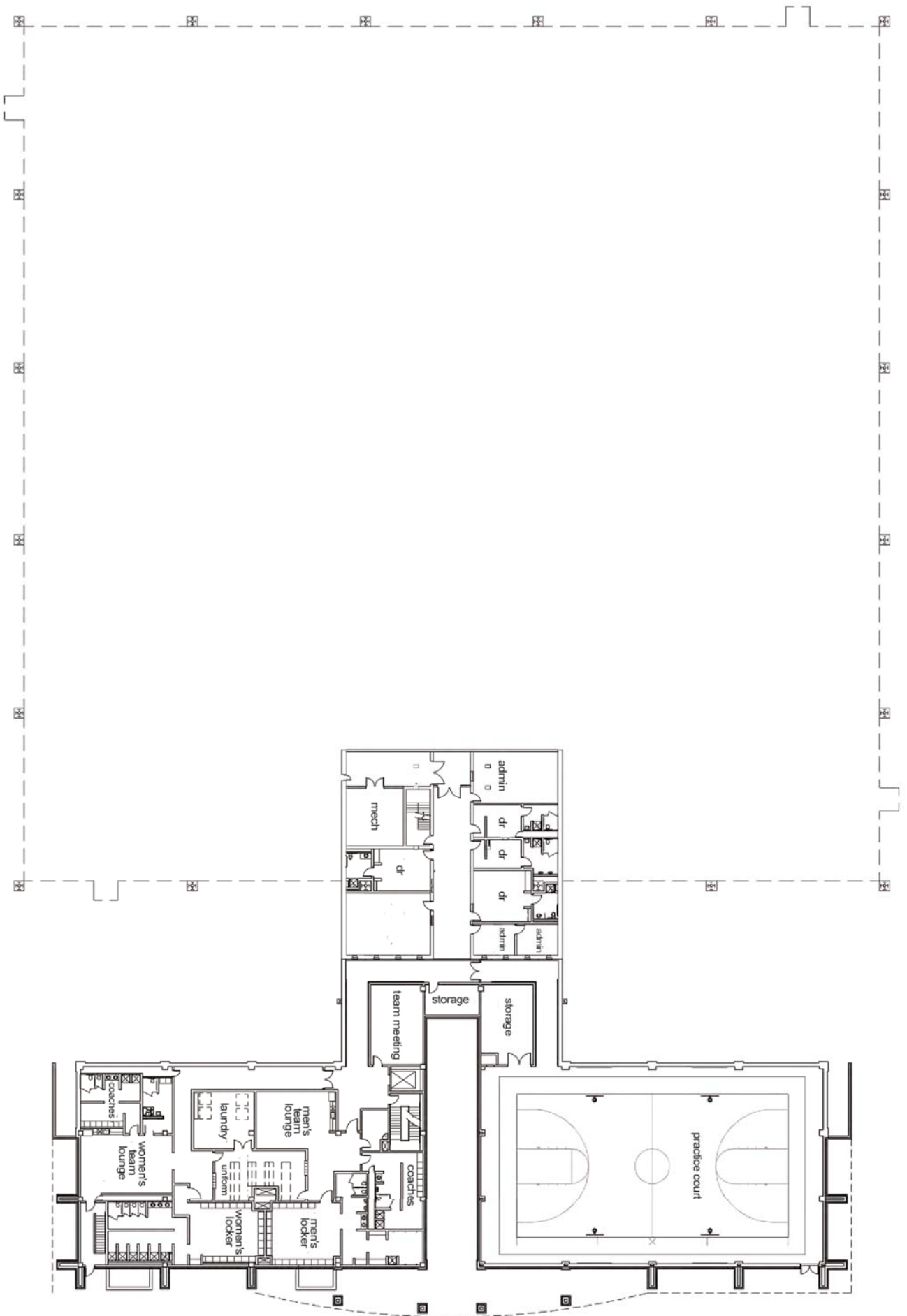

backstage accommodations